



Powered by:  **FPT**
POWERTRAIN TECHNOLOGIES

N67 TM1

6.7 Liter
EPA Tier III

Specifications are subject to change without notice.

Electrical Performance

Voltage	Option 1	Option 2	Phase	Frequency	Amperage(1)	kW	kVa	P.F.
120/240 Zig-Zag	-	X	Single	60 Hz	328	79	79	1.0
120/240 Delta(2)	X	-	Single	60 Hz	218	52	52	1.0
120/208 Low Wye	X	X	Three	60 Hz	364	105	131	0.8
120/240 Delta	X	-	Three	60 Hz	315	105	131	0.8
139/240 Low Wye(3)	-	X	Three	60 Hz	294	100	125	0.8
277/480 High Wye	X	X	Three	60 Hz	172	115	143	0.8

Notes: (1) Maximum current at terminal block. (2) 120/240V 1-PH is available by pulling two phases off the 120/240V Delta connection. (3) 139/240V 3-PH is available with the rheostat adjustment from the 120/208V Low Wye connection. (4) Option 1 and Option 2 are three position switches.

WINPOWER has over 85 years experience manufacturing industrial grade generators. Our mobile diesel units are built to handle standby and prime power applications. We are able to give customers the best long-term value by using high quality components with proven engineering designs. Every **WINPOWER** generator is manufactured in our Le Center, Minnesota facility.

Generator Specifications

Rating	125/40°C (Standby)
Type	4 Pole - Revolving Field
Speed	1800 rpm
Insulation System	Class H
Connection	12 Lead
Stator Windings	Double Layer Concentric
Pitch	2/3
Harmonic Distortion	<5%
Efficiency Peak	~93.5%
Coupling	Flexible Disc
Bearing (Maintenance Free)	1
Automatic Voltage Regulation	+/- 1.5%

Engine Specifications

Make	FPT
Model	NEF67 TM1X
Type	Diesel
Gross Horsepower-Standby	201 HP
Injection System	Direct
Speed Governor	Mechanical
Cylinders	6
Total Displacement	6.7 L
Bore x Stroke	mm 104 X 132
Aspiration	Turbocharged
Total Cooling Capacity	6.6 gal
Lube Oil Spec	10W 30 API CF-CH4
Fuel Spec	EN 590
Exhaust Outlet Size @ Muffler	5.0 in
Electrical System (Negative Ground)	12 VDC
Alternator	90 Amps
Battery (Not Included)	BCI 31 900 CCA

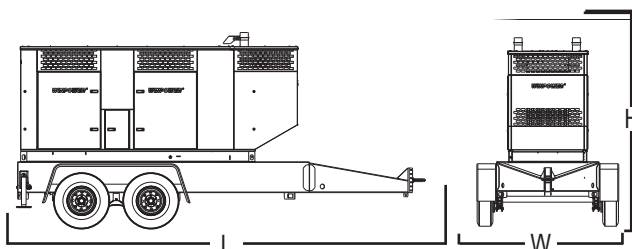

Critical Dimensions (inches)

	L	W	H	LBS
Module w/ Trailer	183	64	96	6500
Module w/out tank	135	40	62	5150

77 dB(A)

Safety

At WINPOWER, we take safety seriously. The DX100 is designed with numerous safety features that help to protect personnel and equipment.

- Dual circuit breakers for high and low voltage overcurrent protection
- Automatic shutdowns protect the terminal block connections from access during operation
- Automatic shutdown if an operator attempts to change voltages while the generator is operating
- Belts and pulleys are protected from unintentional access with guards
- Sophisticated electronic controls monitor engine and generator parameters to detect problems to warn operators and/or shut down the system

Controller

- Digital control/instrument panel resets safety parameters automatically for the selected voltage
- Lead connections are easy to connect to terminal block
- DC power disconnect switch preserves the battery when the generator is not in use
- Front panel USB connection allows easy access for service
- Front panel voltage adjustment rheostat
- All engine and generator metering is digital

Receptacle Package

- Full overcurrent protection
- 2xNEMA 5-20 GFCI duplex receptacles
- 2x50A Twist-Lock (CS6369C) receptacles
- Full power terminal block
- Shore power allows the standard block heater and battery charger to be powered with a standard extension cord

Trailer Features

- DOT approved diesel tank and trailer
- 10,000 lbs GVWR with electric brakes
- 2 5/16" coupler included standard
- Couplers are bolt on allowing the operator to quickly change devices and adjust the coupler height to better accommodate a variety of tow vehicles
- Front and rear stabilizing jacks included standard
- Optional spare tire and steel tool box available
- Tire Size: 225/75 15

Fuel Consumption

100% Load 7.71 Gallons/Hr.

80% Load 6.78 Gallons/Hr.

50% Load 4.67 Gallons/Hr.

*** 175 gallon single wall tank standard

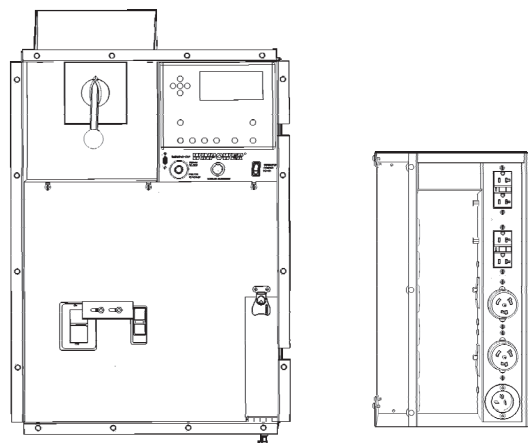

Selector Switch Features

Option 1

- 3 Position: 120/208 3-PH Low-Wye, 120/240 3-PH delta (120/240 1-PH is available using two poles excluding wild leg) 277/480 3-PH High-Wye

Option 2

- 3 Position: 120/240 1-PH Zig-Zag, 120/208 3-PH Low-Wye (139/240 3-Ph available with rheostat adjustment) 277/480 3-PH High-Wye

Derating Factors

- Temperature > 104° F: 3% per 10° F
- Altitude > 1000 ft: 3% per 1000 ft
- Prime Power: 10%

Warranty

WINPOWER warrants its products to be free from defects in material and workmanship for one year or 1000 hours. The engine warranty is administered through FPT's service network for one year unlimited hours.

Accessories/Options:

- Battery Charger (Standard)
- Block Heater (Standard)
- Two Wire Start (Standard)
- 300 Gallon Fuel Tank
- Cam-Lock
- 3" Pintle
- 50 A Twist-Lock Plug
- Cam-Lock Plug
- Spare Tire
- Tool Box