

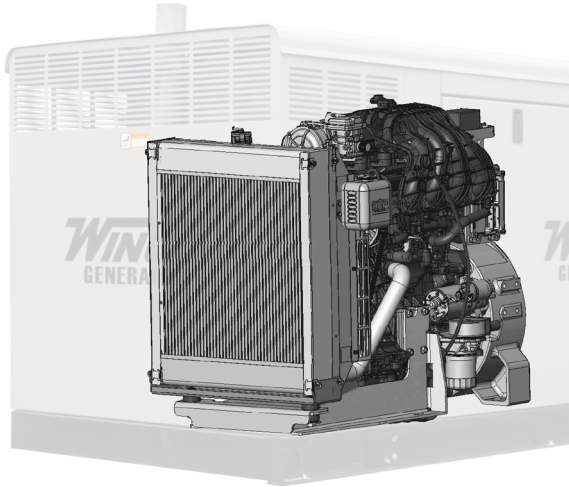

Industrial Ford Engine



Brushless Industrial Genend.



Assembled in the USA  
Engineered, fabricated, and assembled in Minnesota



Full Load Tested  
Every generator is 100% load tested



DSE 7310 Controller  
Provides immediate performance information



Coolant Heater  
120V in-line Hotstart coolant heater with thermostat



Battery Charger  
5 Amp, smart marine charger standard



Galvanealed Steel Enclosure  
Durable design with powder coat paint

UL2200 Listed  
A safety standard for the design, construction, and performance of stationary generators

# SPECIFICATIONS

## ELECTRICAL

VOLTS	POWER FACTOR	LP			NG			MAIN CIRCUIT BREAKER AMPS
		WATTS	KVA	AMPS	WATTS	KVA	AMPS	
120/240 1-PH	1.0	21,000	21,000	88	21,000	21,000	88	90
120/208 3-PH	0.8	22,000	27,500	76	22,000	27,500	76	80
120/240 3-PH	0.8	22,000	27,500	66	22,000	27,500	66	80
277/480 3-PH	0.8	24,000	30,000	36	24,000	30,000	36	35

## ENGINE

ENGINE MANUFACTURER	FORD
ENGINE MODEL	MSG-425
ENGINE STARTER	12V ELECTRIC
ENGINE SPEED	1800 RPM
ENGINE CYLINDERS	4
HP RATING	
NG	47
LP	49
FREQUENCY	60 HZ
TORQUE	
NG	137 FT/LBS
LP	140 FT/LBS
ALTERNATOR	95 AMPS
FLYWHEEL	10"
ROTATION	CCW
ASPIRATION	NATURAL
EXHAUST OUTLET	3"
BORE/STROKE	89 mm x 100 mm
DISPLACEMENT/TYPE	2.5 L
LOW OIL PROTECTION	STANDARD
RECOMMENDED OIL <sup>(1)</sup>	5W-20 SAE
OIL CAPACITY	7 QT
GOVERNOR	ELECTRONIC
COMPRESSION RATIO	9.7:1
FAN TYPE	PUSHER
COOLANT CAPACITY	6.6 QT
HIGH COOLANT TEMP PROTECTION	STANDARD
COMBUSTION AIR	67.54 CFM
RADIATOR COOLING AIR	4420 CFM

NOTES: (1) The recommended oil is for normal applications. See operator's manual for the recommended oil for your needs.

## PSS21

MOTOR STARTING (CODE G)	7 HP
DBA @ 7 METERS	75
TOTAL HARMONIC DISTORTION	< 5%
FLOATING NEUTRAL	YES
ASSEMBLED IN	USA
UL CERTIFICATION	UL2200 LISTED
EPA APPROVED	STANDBY ONLY
CSA APPROVED	YES
UNIT WARRANTY <sup>(1)</sup>	2 YR/2000 HRS

NOTES: (1) For more generator warranty, see operator's manual.

## GENERATOR END

WINDING	
SINGLE PHASE	4 LEAD
THREE PHASE	12 LEAD
WINDING NUMBER	
SINGLE PHASE	706
THREE PHASE	711
VOLTAGE REGULATION	AVR +/- 1%
AVR TYPE	AS540
TEMPERATURE RISE	125/40° C
TYPE	REVOLVING FIELD
BRUSHLESS	YES
SPEED	1800 RPM
ROTOR	2/3 PITCH
WINDINGS	100% COPPER
STATOR WINDING	
706	SINGLE LAYER CONCENTRIC
711	DOUBLE LAYER CONCENTRIC
COUPLING	DIRECT/FLEXIBLE DISC
BEARINGS	SINGLE (MAINTENANCE FREE)
EFFICIENCY PEAK	
SINGLE PHASE 1.0 PF	79.6
THREE PHASE 0.8 PF	87.7
INSULATION	CLASS H
INGRESS PROTECTION	IP23

# SPECIFICATIONS

## DERATES

ABOVE SEA LEVEL PER 1,000 FT	4%
TEMPERATURE EVERY 42°F ABOVE 77°F	2%

## FUEL

INLET PRESSURE	4-6 OZ/7-11" WATER COLUMN
FUEL INLET SIZE	3/4"
FUEL CONSUMPTION NG	
100%	261 FT <sup>3</sup> /HR - 264,915 BTU/HR
75%	214 FT <sup>3</sup> /HR - 217,210 BTU/HR
50%	166 FT <sup>3</sup> /HR - 168,490 BTU/HR
25%	119 FT <sup>3</sup> /HR - 120,785 BTU/HR
0%	71 FT <sup>3</sup> /HR - 72,065 BTU/HR
FUEL CONSUMPTION LP	
100%	2.9 GAL/HR - 263,900 BTU/HR
75%	2.4 GAL/HR - 218,400 BTU/HR
50%	1.9 GAL/HR - 172,900 BTU/HR
25%	1.4 GAL/HR - 127,400 BTU/HR
0%	0.90 GAL/HR - 81,900 BTU/HR

## SHIPPING

SHIPPING DIMENSIONS (L x W x H)	86" x 40" x 51"
SHIP WEIGHT	1,570 LBS
FREIGHT CLASS	70

## BATTERY

DC SYSTEM	12V
DC ALTERNATOR	ENGINE MOUNTED
BATTERY RACK/CABLE	INCLUDED
BATTERY CHARGER	5 AMP INCLUDED
REQUIRED BATTERY <sup>(1)</sup>	GROUP 24 650 CC

Notes: (1) Battery not included.

## OPTIONAL ACCESSORIES

GENERATOR STRIP HEATER

AUTOMATIC TRANSFER SWITCH

VAPOR FUEL STRAINER

BATTERY CHARGER UPGRADE

BATTERY HEATER

NFPA 110 LEVEL 1

WEBNET

LP LIQUID WITHDRAWAL

## DSE 7310 CONTROLLER

### ENGINE DISPLAY/PROTECTION

ENGINE RPM	YES
LOW OIL PRESSURE	YES
HIGH COOLANT TEMP	YES
LOW COOLANT	OPTIONAL
OVER/UNDER SPEED	YES
OVER CRANK	YES
CAN ECU SHUTDOWN	YES
ENGINE MAINTENANCE CODES	YES

### GENSET DISPLAY/PROTECTION

VOLTAGE (L-N & L-L)	YES
OVER/UNDER VOLTAGE	YES
FREQUENCY	YES
OVER/UNDER FREQUENCY	YES
AMP DISPLAY/SHUTDOWN	YES
PHASE IMBALANCE	DISABLED
KW, KVA, KVAR DISPLAY	YES
KWH, KVAH, KVARH DISPLAY	YES
GENERATOR PHASE SEQUENCE	OPTIONAL

### ADDITIONAL DISPLAYS/PROTECTIONS

EXTERNAL E-STOP	CUSTOMER SUPPLIED
BATTERY VOLTAGE	YES
BATTERY OVER/UNDER VOLTAGE	YES

### COMMUNICATIONS

USB CONNECTABLE	YES
RS232/RS485	YES
REMOTE DISPLAY PANEL	OPTIONAL
DSE WEB NET	OPTIONAL

### ADDITIONAL FEATURES

AUDIBLE ALARM	YES
ENGINE EXERCISER	DISABLED
MAINTENANCE INTERVAL TIMER	DISABLED
LOAD SHEDDING/DUMMY	DISABLED
CONFIGURABLE INPUTS	4 (EXPANDABLE)
CONFIGURABLE OUTPUTS	4 (EXPANDABLE)
EVENT LOG	250

Specifications are subject to change without notice.



# DRAWINGS

## OPEN SKID

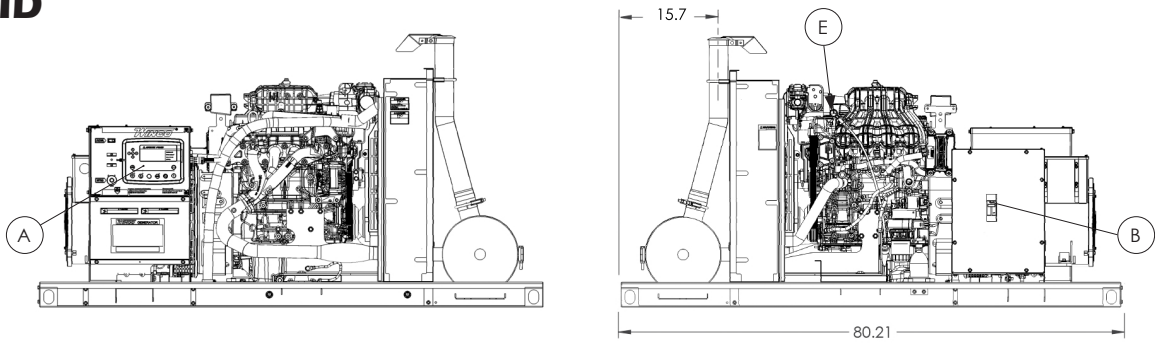

KEY COMPONENTS	
A	ENGINE CONTROL
B	MAIN LINE CIRCUIT BREAKER
C	GROUP 24 BATTERY (NOT INCLUDED)
D	OIL FILL
E	OIL DRAIN
F	OIL DIPSTICK
G	OIL FILTER
H	FUEL INLET
I	AIR FILTER
J	COOLANT DRAIN
K	COOLANT FILL
L	AVR
M	BATTERY CHARGER

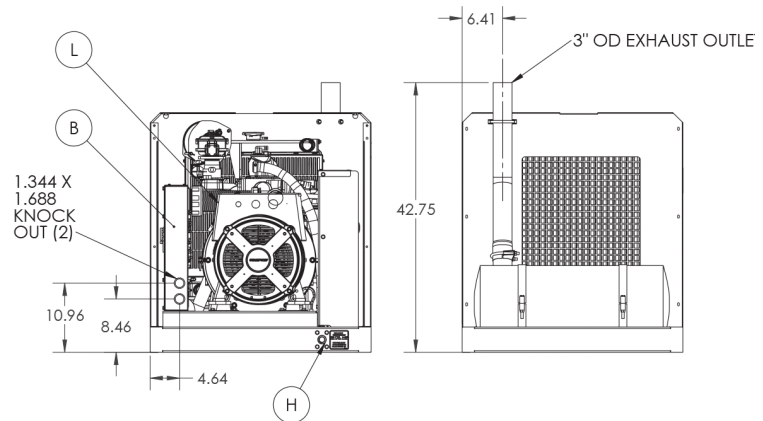

## ENCLOSED

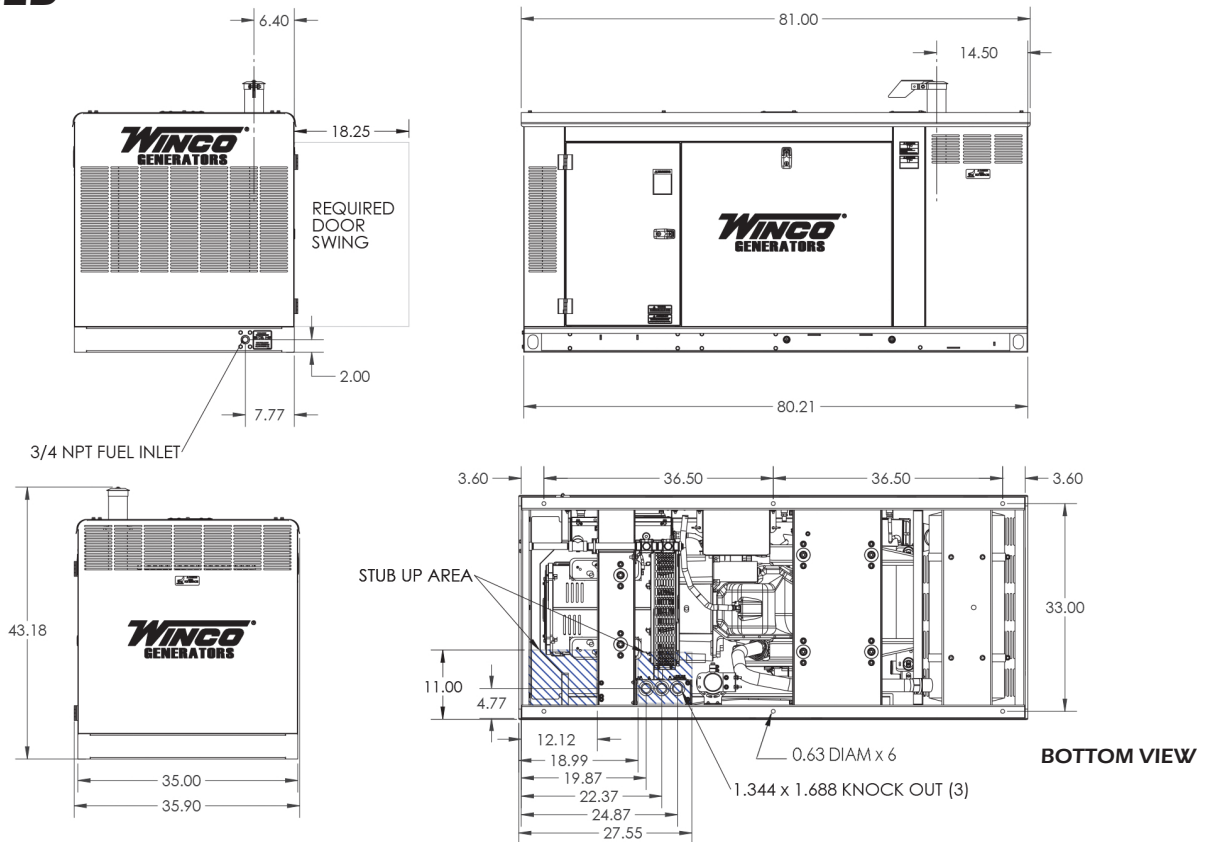

Specifications are subject to change without notice.

